

A versatile solution for diverse business needs

Offering super-fast printing speeds and excellent output quality, the ECOSYS MA4000wifx enhances productivity while keeping printing costs remarkably low. This all-rounder is designed to keep up with the demands of large organisations, supporting Wi-Fi Direct for optimal flexibility.

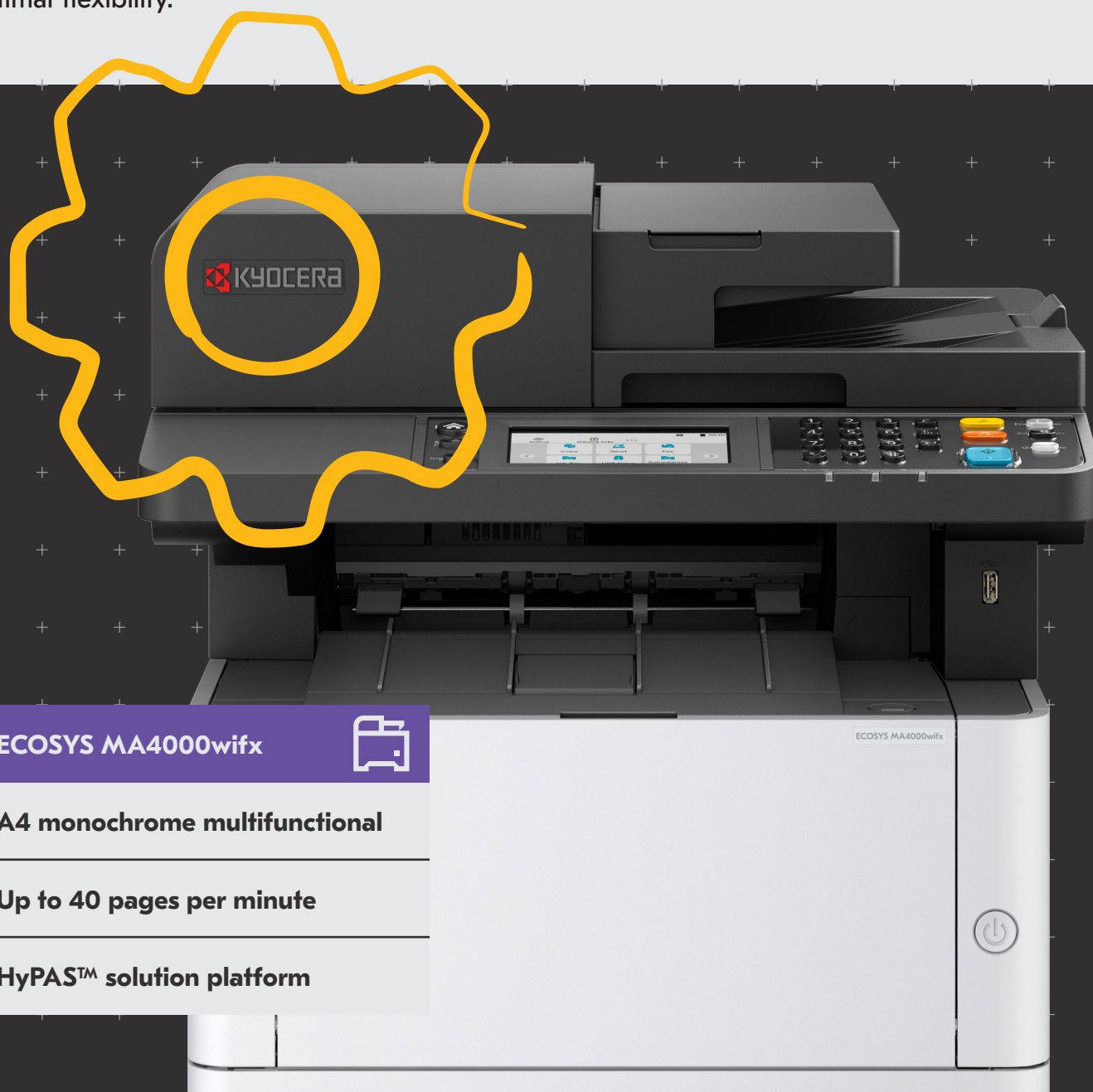

ECOSYS MA4000wifx



A4 monochrome multifunctional

Up to 40 pages per minute

HyPAS™ solution platform

Specifications

GENERAL

KYOCERA ECOSYS Laser Monochrome Multifunctional HyPAS™ solution platform¹

Operation panel: 10.9 cm (4.3 inch) full-colour touch panel display

Type: Desktop

Engine speed:

Up to 40 A4 pages per minute simplex (single-sided),
Up to 20 A4 pages per minute duplex (both sides)

Resolution: 1200 x 1200 dpi (print),
600 x 600 dpi (scan/copy)

Recommended Print Volume²: Average 2,000 pages per month

Maximum Print Volume²: 80,000 pages per month

Maximum Life²: 200,000 pages or 5 years

Recommended Scan Volume²: Average 830 pages per month

Warm-up time: Approx. 29 seconds or less (after switching on)

Time to first print: Approx. 6.4 seconds or less

Time to first copy: Approx. 7.4 seconds or less (DP),
Approx. 6.4 seconds or less (Platen)

CPU: ARM Cortex-A53, 1.0GHz

Memory: Standard 2GB

Standard interface: USB 2.0 (Hi-Speed), Network (10BASE-T/100BASE-TX/1000BASE-T), WLAN (802.11a/b/g/n/ac, Wi-Fi Direct, 2.4/5 GHz), USB host for USB flash memory, slot for optional SD/SDHC card

Integrated accounting: 100 department codes

Dimensions (W x D x H):

Without packaging: 417 x 412 x 437 mm,
With packaging: 555 x 541 x 572 mm

Weight:

Without packaging: Approx. 19.5 kg (with bundled toner), Approx. 19.0 kg (without bundled toner)
With packaging: 24 kg

Power source: AC 220 ~ 240 V, 50/60 Hz

Power consumption:

Printing/Copying: 574.4 W
Ready mode: 11 W
Sleep-mode: 0.4 W

Noise (sound pressure level: ISO 7779/ISO 9296):

Printing/Copying: 52 dB (A)
Quiet mode: 48 dB (A)
Stand-by: 29 dB (A)

Safety standards: TÜV/GS, CE

This unit is manufactured according to ISO 9001 quality standard and ISO 14001 environmental standard

PAPER HANDLING

All paper capacities quoted are based on paper thickness of max. 0.11 mm. Please use paper recommended by KYOCERA under normal environmental conditions.

Input capacity: Multi-purpose tray: 100 sheets, 60–220 g/m², A6, A5, A4, custom (70 x 148 – 216 x 356 mm). Standard universal paper cassette: 250 sheets, 60–163 g/m², A6, A5, A4, custom (105 x 148 – 216 x 356 mm). Max. input capacity with options: 850 sheets.

Duplex: Standard duplex unit, two-sided printing, 60–163 g/m², A5, A4, custom (140 x 210 – 216 x 356 mm).

Document Processor: max. 50 originals, dual scan, 50–160 g/m², A6, A5, A4, custom (100 x 148 – 216 x 356 mm).

Output capacity: Max. 150 sheets (face-down) with paper full detection

PRINT FUNCTIONS

Controller language: PRESCRIBE

Emulations: PCL 6 (5e, XL), KPDL3 (PostScript 3 compatible), Lineprinter, IBM Proprinter, Epson LQ-850, PDF Direct Print 1.7, 2.0, XPS/Open XPS Direct Print, TIFF Direct Print

Operating systems: All current Windows operating systems, MAC OS X Version 10.9 or higher, Chrome OS, as well as other operating systems on request.

Fonts/barcodes: 93 outline fonts (PCL6, KPDL3), 4 fonts (Calibri), 4 fonts (Cambria), 1 Bitmap font, 45 one-dimensional barcodes (e.g. EAN-8, EAN-13, EAN-128), as well as support for two-dimensional barcodes PDF417 under PRESCRIBE (PCL and other barcodes available an option)

Print features: "Proof and hold", Job storage³, Quick copy³, Private print³, Data storage method with PIN code or password³, Internet printing IPP 1.0, E-mail printing, WSD Print, EcoPrint – toner save mode, AirPrint, Mopria, Microsoft Universal Print, Job batch output, Image Refinement, Pull print, VPSX, IPP PIN Print, Kyocera Cloud Access, optional Kyocera Cloud Print and Scan

Security features: Secure Boot, Run-time Integrity Check, Allowlisting, TLS 1.3, IPsec, HTTPS, SNMPv3, S/MIME, "Confidential printing" with PIN code request³, encrypted PDF direct printing, Security Watermark, electronic PDF signature, IPP over TLS, WSD, local and network authentication, Windows authentication (NTLM v2, Kerberos), Restriction of the user group through user login administration, IP filtering, port number restriction, blocking of interfaces, Security Quick Setup, Administrator Authentication on Firmware Update, SIEM Support (SysLog), SCEP, OCSP/CRL, Wi-Fi Certified WPA3, optional TPM (Trusted Platform Module)

Mobile printing support: KYOCERA Mobile Print app for iOS and Android, AirPrint, Mopria, Microsoft Universal Print, Wi-Fi Direct.

COPY FUNCTIONS

Max. original size: A4/Legal

Continuous copying: 1–999

Zoom range: 25–400% in 1% steps

Preset magnification ratios: 7 Reductions/5 Enlargements

Image adjustments: Text + Photo, Photo, Text, Chart/Map, Printed document

Features: Multiple copies from memory, electronic sorting, blank page skip, line skip, duplex copy, 2-in-1 and 4-in-1 function, split mode, DP auto-cropping, ID card copy supporting auto crop, folded corner detection, continuous scan, priority override, Eco Print (copy) – toner save mode, specific color removal, border erase, auto paper selection, manual and auto background density adjustment, manual and auto reduction/enlargement

SCAN FUNCTIONS

Functionality: Scan to Email, Scan to FTP, Scan to PC (SMB), TWAIN, WIA, WSD Scan, Scan to USB Host, Distributed File System (Windows 2012 server or later), WebDAV available using HyPAS software development kit, eSCL support (AirPrint, Mopria Scan, Chrome OS)

Scan speed Simplex: 40 ipm (300 dpi, A4, b/w)
23 ipm (300 dpi, A4, colour)

Scan speed Duplex: 80 ipm (300dpi, A4, b/w)
46 ipm (300 dpi, A4, colour)

Scan resolution: 1,200 (with TWAIN and WIA driver), 600, 400, 300, 200 dpi, 256 greyscales per colour

Max. scan size: A4/Legal

Original recognition: Text, photo, text + photo, light text/ fine line, optimised for OCR

File types: PDF, PDF/A-1, PDF/A-2, high compressed PDF, encrypted PDF, JPEG, TIFF, (Open) XPS

Compression method: MMR/JPEG

Features: Active Directory support, LDAP over TLS, internal address book, Multi Sending – simultaneous sending to email, SMB, FTP and fax, file separation, skip blank pages, line skip, folded corner detection, continuous scan, digital signature (PDF, Encrypted PDF), auto color select, scan resolution, specific color removal, border erase, manual density adjustment, saturation adjustment, text readability improvement, DP auto-cropping, Multiple cropping¹

FAX FUNCTIONS

Compatibility: Super G3

Modern speed: Max. 33.6 kbps

Transmission speed: Max. 3 seconds (JBIG)

Scanning speed: 2 seconds or less

Address book: 300 entries

Scanning density:

Normal: 8 dot/mm x 3.85 line/mm (200 x 100 dpi)
Fine: 8 dot/mm x 7.7 line/mm (200 x 200 dpi)
Superfine: 8 dot/mm x 15.4 line/mm (200 x 400 dpi)
Ultrafine: 16 dot/mm x 15.4 line/mm (400 x 400 dpi)
Halftone: 256 grey scales

Maximum original size: A4/Legal

Compression method: JBIG, MMR, MR, MH

Memory reception: 256 sheets or more

Features: Network Fax, Memory Reception, Fax Polling, Duplex Receive, Multiple Scan, Fax Forwarding, Fax Direct, Scheduled transmission, Sub address, Fax dedicated paper source, Shared Fax Driver, text readability improvement, Received Fax preview function, Unread fax display notification

CONSUMABLES

Average continuous toner yield in accordance with ISO/IEC 19752

TK-1270 Toner Kit: Microfine toner black for 10,000 pages A4. Capacity of starter toner is 3,600 pages A4.

OPTIONS

PF-1100 Paper feeder (max. 2 units): Max. 250 sheets, 60 – 163 g/m²; A6, A5, A4, custom (105 mm x 148 mm – 216mm x 356mm)

CB-1100-B Cabinet: Wooden desk with storage capacity and wheels, approx. 375 x 393 x 510 mm (WxDxH)

SECURITY

UG-33: ThinPrint support

UG-50: TPM (Trusted Platform Module), additional protection of confidential data

USB IC Card Reader + Card Authentication Kit (B): Support for various authentication keys available

WARRANTY

1-year warranty as standard⁴. KYOCERA guarantees the drum and developer for 3 years or 100,000 pages (whichever occurs sooner), provided each device is used and cleaned in accordance with the service instructions.

KYOCERA LIFE

Up to 5-year on-site warranty extensions available for product and options.

WHAT'S IN THE BOX:

Main unit, starter toner for 3,600 pages, Quick Guide, safety instructions, power supply cord, fax cable.

DVD with drivers, software and user manual not included. Computer with internet connection required to download drivers and software.

¹SD/SDHC card is required to use HyPAS applications.

²The device is not designed to achieve the specified volumes in continuous operation. The maximum volumes relate to the use of the print or scan unit and include their use for the printing, copying and scanning functions. Note: In this context, a copied page corresponds to a scanned and a printed page.

³Optional SD/SDHC memory card is required.

⁴Depending on the country.

ECOSYS stands for ECOlogy, ECONomy and SYStem printing. With their long-life components, ECOSYS devices are designed to maximise durability and minimise the total cost of ownership with regard to maintenance, administration and consumables. The cartridge-free system means that only the toner has to be replaced regularly. The modular design concept allows you to add workflow enhancing functions as required. Integrated system software provides long-term cross network compatibility. KYOCERA's long-life components cost you and the environment less.

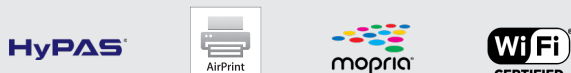

KYOCERA Document Solutions South Africa
90 Bekker Road, Hertford Office Park, Vorna Valley, Midrand
Tel (011) 595 2600
www.kyoceradocumentsolutions.co.za — info@dza.kyocera.com



*KYOCERA Document Solutions does not warrant that any specifications mentioned will be error-free. Specifications are subject to change without notice. Information is correct at time of going to press. All other brand and product names may be registered trademarks or trademarks of their respective holders and are hereby acknowledged.

KYOCERA Document Solutions Partner

JUL2024MA4000wifx/VER1.0